



FIRESTOP CENTRE

Authorised New Zealand Distributor
Ph (09) 483 4000 www.firestopcentre.co.nz

FIRESTOP Duct Wrap-25 Circular duct (up to 300mm diam) Plasterboard wall (1x13mm or 2x13mm) Internal Fire



Report RPF24071, Pages 4,11
FAS AS1530.4-2014 AS4072.1-2005

System ID# FC401

Products	FIRESTOP Duct Wrap-25 FIRESTOP Ultra Sealant
Application	Fire stopping of circular duct penetrating a plasterboard wall
Construction	Plasterboard wall min 90mm thick steel or timber stud with 1 or 2 layers of 13mm fireboard

Fire Classification

NOTE: For general instructions on installing FIRESTOP Duct Wrap-25 see [Installation Instructions](#) sheet on Firestop Centre website.

Internal Fire

For 1 x 13mm walls 60min:

Single layer wrap	FRR 60/60/30
Add 1300mm second layer	FRR 60/60/60

For 2 x 13mm walls 120min:

Single layer wrap	FRR 120/120/30
Add 1300mm second layer	FRR 120/120/60

INSTALLATION INSTRUCTIONS

- Aperture must be framed in a square leaving 10-30mm annular gap to the duct.
- Cut a circular aperture in the plasterboard with an annular gap of 10-30mm to the duct. No lining required.
- Seal each side of the wall with FIRESTOP Ultra Sealant to the depth of the plasterboard.
- Apply a bead of sealant to the wall and attach 0.8mm thick slotted steel angle 75mm x 75mm bent around the duct on all sides.
Fix to the duct with steel rivets 10mm x 5mm diam at 100mm centres in the centre of the angle.
Fix to the wall with plasterboard screws (min 40mm) at 200mm centres high enough to clear the annular space. Fix at all points where framing is available and every second slot in between.
Seal any joints or gaps with FIRESTOP Ultra Sealant.
- Apply a 20mm fillet of FIRESTOP Ultra Sealant at the wall/angle joint and the duct/angle joint.
- Install the Firestop Duct Wrap layers as specified and seal the wrap/wall junction with FIRESTOP Ultra Sealant.

NOTE: Diagram shows 2 layer system, but see details on right for number of layers

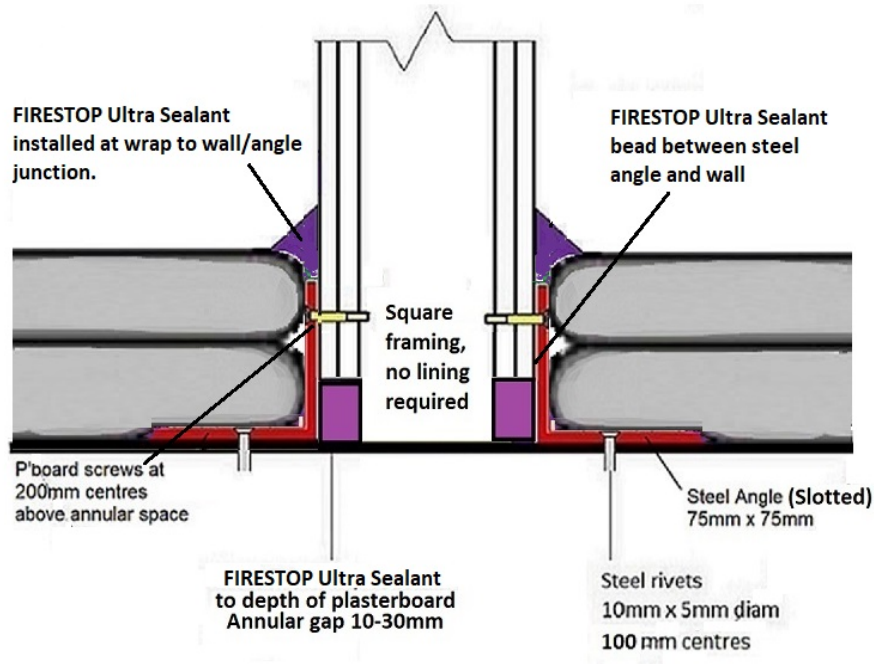

As a part of our policy of on-going product development and testing, we reserve the right to modify, alter or change product specifications without giving notice. All information contained in this document is given in good faith and is provided for guidance only. Any drawings provided are for illustrative purposes only. As Firestop Centre has no control over the methods or competence of installation and of prevailing site conditions, no warranties, expressed or implied are intended to be given as to the actual performance of the product mentioned or referred to herein and no liability whatsoever will be accepted for any loss, damage or injury arising from the use of the information given.

For all technical details on the products specified please refer to the technical data sheets that can be found on www.firestopcentre.co.nz

Signed and approved:



Firestop Centre Ltd
657 Great South Road
Epsom, AUCKLAND

Sheet size: **A4**
Drawn date & no: **20/5/24**